

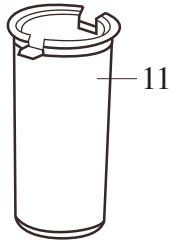

019972
Cleaning Brush

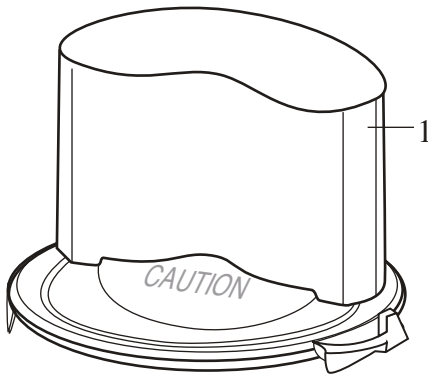

013304
NSF Seal

FP2000 *no longer in production*
FP2100 *no longer in production*
FP2200 /Batch Bowl & Continuous Feed
FP2200U /Unipro with CAF22 & CAF26

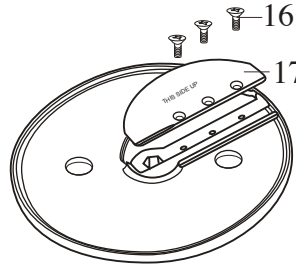
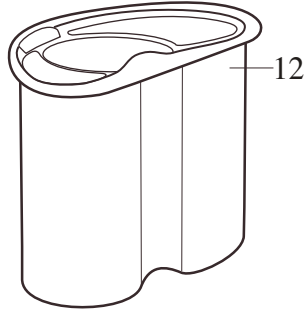
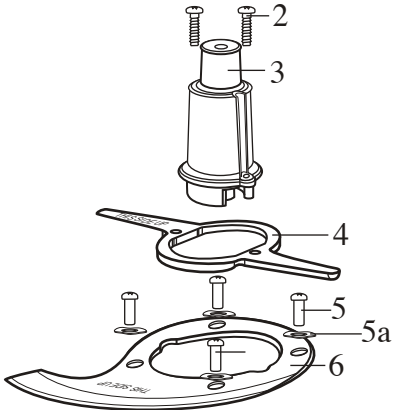

024165
1/8" Slicer (CAF12)

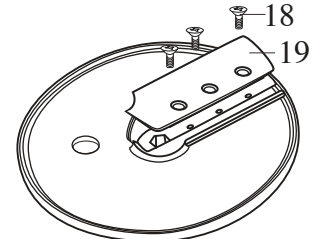

024171
1/2" Slicer (CAF18)

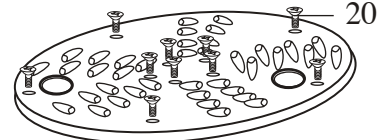
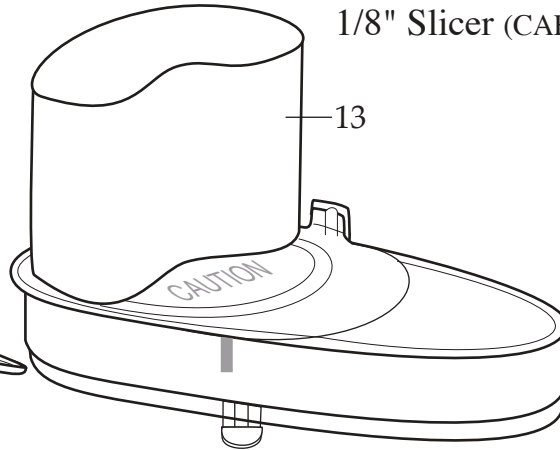
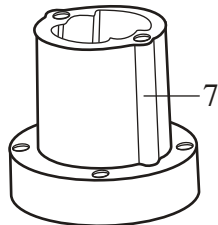

024173
3/16" Shredder (CAF20)

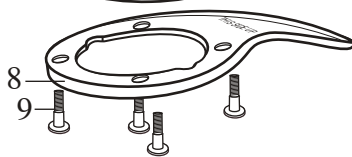

503341
S Blade Cutter Assembly

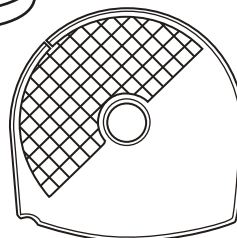
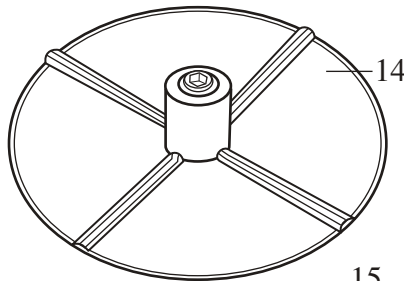
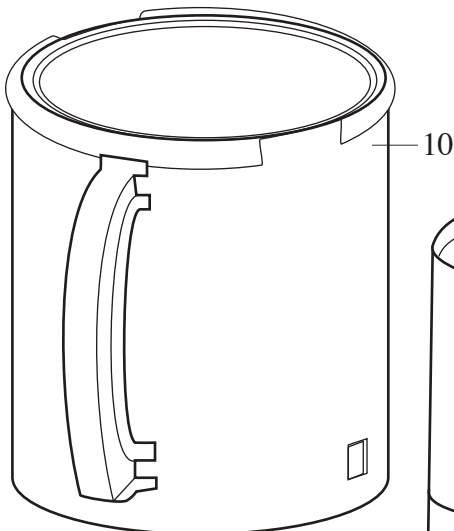

024176
1/2" Dicer (CAF24)

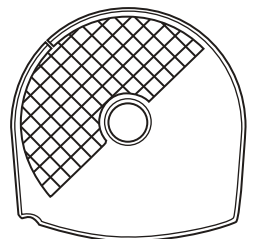

024177
3/4" Dicer (CAF25)

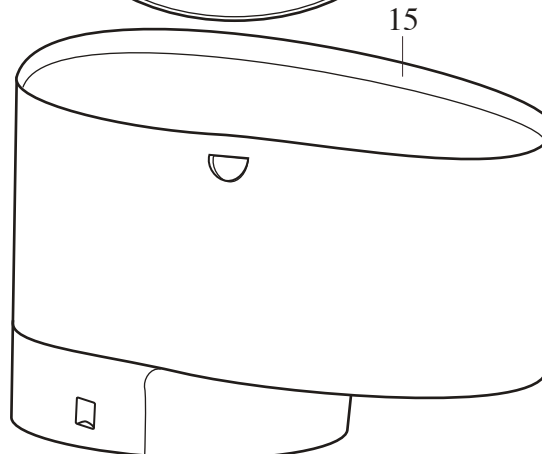

Unit Information

50/60 HZ
12.0 Amps.
3/4 HP
Round work bowl can hold
4 qts. wet and 6 qts. dry
Continuous feed can process
1,400 lbs. per hour

WARING COMMERCIAL®

FP2000 *no longer in production*

FP2100 *no longer in production*

FP2200 /Batch Bowl & Continuous Feed

FP2200U /Unipro with CAF22 & CAF26

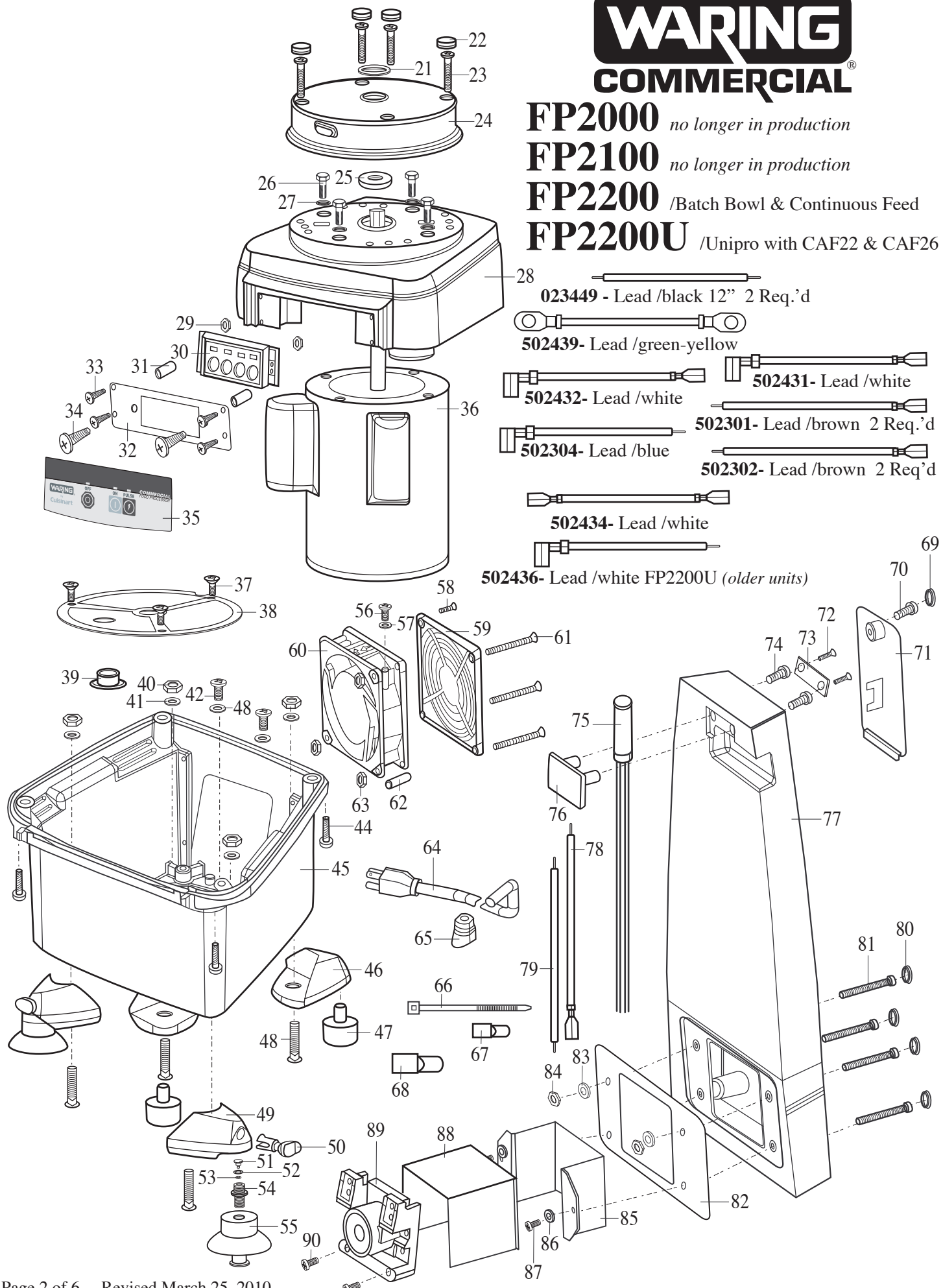

502349 - Lead /black 12" 2 Req.'d

502439- Lead /green-yellow

502432- Lead /white **502431**- Lead /white

502301- Lead /brown 2 Req.'d

502304- Lead /blue **502302**- Lead /brown 2 Req.'d



502434- Lead /white

502436- Lead /white FP2200U (*older units*)

Catalog
 FP2000
 FP2100
 FP2200/FP2200U

Model
 32FP18
 32FP19
 32FP20

Waring Factory Service Center
 314 Ella T. Grasso Ave.
 Torrington, CT 06790
 Tele. 1-800-269-6640
 Fax 860-496-9017
 www.waringproducts.com

Illustration #	Part #	Description
1	502503	Batch Bowl Cover Assy.
2	024005	Screw 2 Req.'d
3	029372 023988	Top Center Hub (<i>current production & 3rd generation</i>) Top Center Hub (<i>2nd generation & older units</i>) N/A Use 503341
4	019670	Mid Blade
5	029370 019984	Special Nut 4 Req.'d (<i>current production & 3rd generation</i>) Special Nut 4 Req.'d (<i>2nd generation & older units</i>) N/A Use 503341
5a	029371	Wave Washer 4 Req.'d (<i>current production</i>)
6	030333	Cutter Blade
7	029373 023989	Center Hub (<i>current production</i>) Center Hub (<i>2nd generation & older units</i>) N/A Use 503341
8	023940 019580	Cutter Blade (<i>current production & 3rd generation</i>) Lower "S" Blade Cutter (<i>2nd generation & older units</i>) N/A Use 503341
9	029369 023029	Special Screw 4 Req.'d (<i>current production & 3rd generation</i>) Special Screw 4 Req.'d (<i>2nd generation & older units</i>) N/A Use 503341
10	019578	Batch Bowl
11	025285 024032 019834	Plunger Insert /dark gray (<i>current production & 2nd generation</i>) Plunger Insert /light gray (<i>older units</i>) Plunger Insert /clear (<i>older units before Sept. 99</i>)
12	025284 019579	Plunger /dark gray- kidney shape  Plunger /white - half circle shape (<i>older units before Sept. 99</i>) 
13	502583 502504 502293	Continuous Feed Cover Assy. /kidney plunger (<i>current production</i>) Continuous Feed Cover Assy. /kidney plunger (<i>older units</i>) Continuous Feed Cover Assy. /half circle plunger (<i>older units before Sept. 99</i>)
14	025286	Slinger Disk /gray
15	025281 019581	Continuous Feed Bowl /dark gray (<i>current production & 2nd generation</i>) Continuous Feed Bowl /light gray (<i>older units</i>)
16	019983	Flat Head Screw 3 Req.'d
17	019689	Slicing Blade
18	023464	Flat Head Screw 3 Req.'d
19	023055	Slicing Blade
20	019981	Screw 10 Req.'d
21	018008	Washer
22	025294 019812	Plug 4 Req.'d /dark gray (<i>current production & 2nd generation</i>) Plug 4 Req.'d /light gray (<i>older units</i>) 4 Req.'d
23	019974	Screw 4 Req.'d
24	019566	Locking Ring
25	018004	Seal
26	020325	Hex Bolt 4 Req.'d
27	021082	Washer 4 Req.'

Catalog

FP2000
 FP2100
 FP2200/FP2200U

Model

32FP18
 32FP19
 32FP20



Illustration #	Part #	Description
28	502963	Top Housing /dark gray (<i>current production & 2nd generation</i>)
	502385	Top Housing /light gray (<i>older units</i>) N/A Use 502963
29	001856	Kep Nut 2 Req.'d
30	019954	Tap Touch Switch
31	019641	Switch Spacer 2 Req.'d
32	019572	Switch Plate
33	019096	Screw 4 Req.'d
34	019973	Screw 2 Req.'d
35	019573	Name Plate
36	019574	Motor 3/4 HP
37	016317	Screw 3 Req.'d
38	023233	Screen /punched
39	023211	Snap Bushing
40	023073	Nut 4 Req.'d
41	018314	Washer 4 Req.'d
42	017408	Screw 2 Req.'d
43	002943	Washer 2 Req.'d
44	019098	Screw 4 Req.'d
45	025282	Bottom Housing /dark gray (<i>current production & 2nd generation</i>)
	019787	Bottom Housing /light gray (<i>older units</i>) N/A Use 025282
46	025292	Rear Foot Support /dark gray 2 Req.'d (<i>current production & 2nd generation</i>)
	019968	Rear Foot Support /light gray 2 Req.'d (<i>older units</i>)
47	018790	Foot 2 Req.'d
48	023072	Carriage Bolt 4 Req.'d
49	024293	Front Foot Support /dark gray 2 Req.'d (<i>current production & 2nd generation</i>)
	024052	Front Foot Support /light gray 2 Req.'d (<i>older units</i>)
50	024037	Front Foot Actuator 2 Req.'d
51	024039	Valve Foot Pin 2 Req.'d
52	024040	Curved Spring Washer 2 Req.'d
53	024042	Foot "O" Ring 2 Req.'d
54	024038	Actuator Shaft 2 Req.'d
55	024053	Suction Cup Foot 2 Req.'d
56	023437	Screw
57	002943	Washer
58	023436	Screw

Catalog
FP2000
FP2100
FP2200/FP2200U

Model
32FP18
32FP19
32FP20

Waring Factory Service Center
314 Ella T. Grasso Ave.
Torrington, CT 06790
Tele. 1-800-269-6640
Fax 860-496-9017
www.waringproducts.com

Illustration #	Part #	Description
59	023412 023454	Fan Guard (<i>current production & 2nd generation</i>) Fan Guard (<i>older units</i>)
60	023411	Fan
61	023416	Screw 3 Req.'d
62	002613	Insulating Sleeve
63	001856	Kep Nut 3 Req.'d
64	014236	Cord Set
65	018811	Strain Relief
66	013731	Cable Tie 3 Req.'d
67	012409	Crimp Connector /small 3 Req.'d
68	019123	Crimp Connector /large 2 Req.'d
69	025294 019812	Plug /dark gray (<i>current production & 2nd generation</i>) Plug /light gray (<i>older units</i>)
70	019978	Screw
71	025288 019055	Back Plate /dark gray (<i>current production & 2nd generation</i>) Back Plate /light gray (<i>older units</i>)
72	019980	Screw 2 Req.'d
73	019979	Clamp Sensor
74	019977	Screw 2 Req.'d
75	021741	Sensor
76	025289 019562	Insert /dark gray (<i>current production & 2nd generation</i>) Insert /light gray (<i>older units</i>)
77	502578	Tower Assembly /dark gray
78	502306	Lead
79	023936	Lead /black 15 1/2"
80	025294 019812	Plug /dark gray 4 Req.'d (<i>current production & 2nd generation</i>) Plug /light gray 4 Req.'d (<i>older units</i>)
81	023325	Screw 4 Req.'d
82	023328	Tower Gasket
83	002943	Washer 2 Req.'d
84	016716	Hex Nut 2 Req.'d
85	023326	Relay Bracket
86	002943	Washer 2 Req.'d
87	016690	Screw 2 Req.'d
88	023360	Splash Guard
89	019569	Relay
90	023347	Screw 2 Req.'d

